

400 SCB/424

Speed control boards

Features and benefits

- Manual speed control by an external potentiometer (not supplied)
- Automatic speed control by 0 to 5 V DC control signal
- Motor stop/start control by remote switch, TTL or CMOS
- Motor may be connected for clockwise or anticlockwise rotation
- Instant direction change
- Power on LED indication
- Prime maximum speed switch
- Board-mounted potentiometer for speed control



Technical specifications

400 SCB/424	
Speed control ratio	20:1
Supply voltage	100 V to 115 V AC 50/60 Hz, 220 V to 240 V AC 50/60 Hz
Operating temperature	-30 °C to 40 °C (-22 °F to 104 °F)

400 SCB/424 dimensions

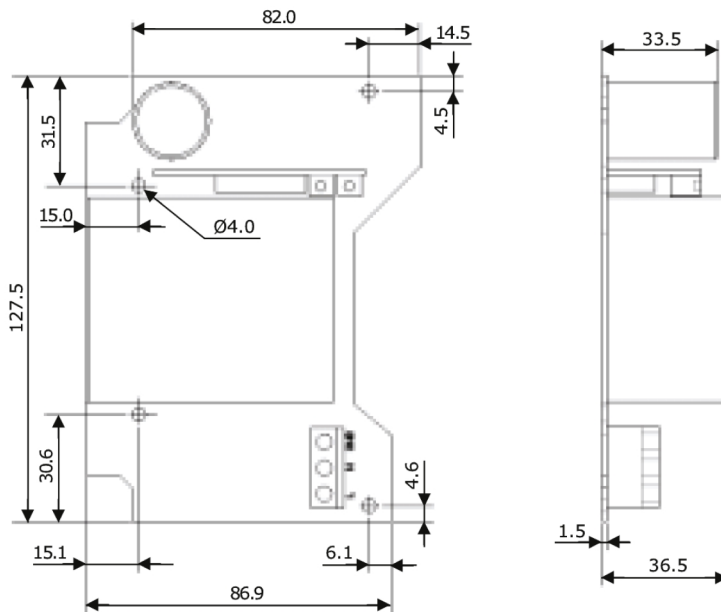

- Remote potentiometer (10Kohm)
- 1 meter cabling

Product codes

Supply voltage	0-12VDC, 5W motor	0-21VDC, 30W motor
100-115VAC 50/60Hz	049.C424.05A	049.C424.30A
220-240VAC 50/60Hz	049.C424.05E	049.C424.30E

Disclaimer: All flow rates shown were obtained pumping water at 20 °C (68 °F) with zero suction and delivery heads. Watson-Marlow, Pumpsil, PureWeld XL, Bioprene and Marprene are trademarks of Watson-Marlow Limited. Disclaimer: The information contained in this document is believed to be correct but Watson-Marlow Limited accepts no liability for any errors it contains, and reserves the right to alter specifications without notice. GORE and STA-PURE are trademarks of W. L. Gore & Associates. Please state the product code when ordering pumps and tubing.



wmfts.com/global
10 July 2025