

Certa Plus 200

Certa Plus process pump

Features and benefits

- Gentle product handling preserves high quality of product
- Impressive suction capability
- Almost zero pulsation
- Outstanding energy efficient pumping principle
- Bi-directional running
- Only one shaft and one seal system
- Different port orientations available, including self-draining position
- Traceability back to base materials



Certa Plus 200 performance

Performance curves

These performance curves show the theoretical flow without consideration of slip

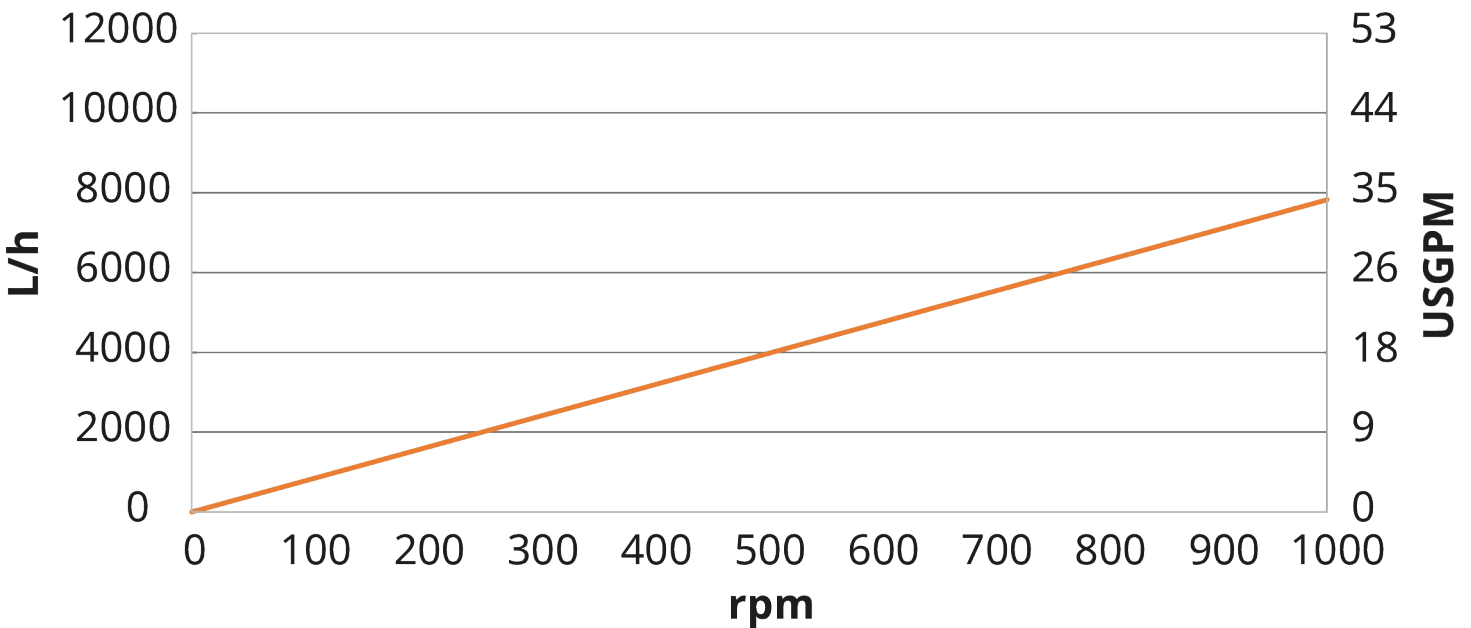

Technical specifications

| | Certa Plus 200 |
|------------------------------|---|
| Volume per revolution | 0.13 l (0.034 USG) |
| Max. particle size | 18 mm (0.71 in) |
| Suction pressure | 85% of a vacuum |
| Max. operating pressure | 6 bar (87 psi) |
| Operating temperature | -20 °C to 100 °C (-4 °F to 212 °F) |
| Max. SIP temperature | 121 °C (250 °F) |
| Standards | 3-A, ATEX, EHEDG Type EI Class I, EHEDG Type EL Class I Aseptic |
| Certification and compliance | EC 1935/2004, FDA, USP Class VI |
| Port orientation | Various options to meet your requirements |
| Port type | Flange, Milk fitting, RJT, SMS, TC |
| Shaft diameter | 28 mm (0.98 in) |
| Shaft height | 109.5 mm (4.31 in) |

Materials of construction

| | Certa Plus 200 |
|---------------|--|
| Housing | Stainless steel 1.4435, Stainless steel 316L |
| Bearing frame | Stainless steel 1.4301, Stainless steel 304 |
| Rotor | Stainless steel 1.4435, Stainless steel 316L |
| Gate | PEEK, PTFE |
| Seals/gaskets | EPDM, FKM |
| Shaft seal | PTFE, SSIC |

Certa Plus 200 dimensions

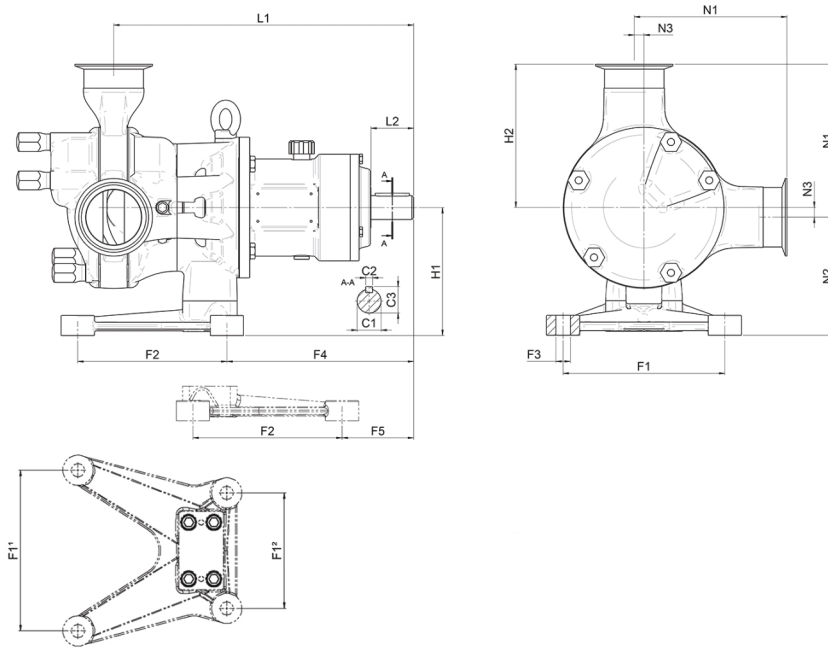

| Model | Nozzles | | | | | | Foot | | | | | Length | | | | Height | | | | Coupling | | | | | | | | | | |
|-------|---------|------|------|------|----|------|------|------|-----|------|-----|--------|-------|------|------|--------|-------|-------|----|----------|-------|------|-----|------|-----|-------|----|------|----|------|
| | N1 | | N2 | | N3 | | F1 | | F2 | | F3 | | F4 | | F5 | | L1 | | L2 | | H1 | | H2 | | C1 | | C2 | | C3 | |
| | mm | in. | mm | in. | mm | in. | mm | in. | mm | in. | mm | in. | mm | in. | mm | in. | mm | in. | mm | in. | mm | in. | mm | in. | mm | in. | mm | in. | mm | in. |
| C200 | 155 | 6.10 | 99.5 | 3.92 | 10 | 0.39 | 120 | 4.72 | 135 | 5.31 | Ø12 | Ø0.47 | 167.5 | 6.59 | 81.5 | 3.21 | 298.5 | 11.75 | 50 | 1.97 | 109.5 | 4.31 | 145 | 5.71 | Ø28 | Ø1.10 | 8 | 0.31 | 31 | 1.22 |

Disclaimer: All flow rates shown were obtained pumping water at 20 °C (68 °F) with zero suction and delivery heads. Disclaimer: The information contained in this document is believed to be correct but Watson-Marlow Limited accepts no liability for any errors it contains and reserves the right to alter specifications without notice. Watson-Marlow, MasoSine, Qdos, ReNu, LoadSure, Bioprene, Pumpsil and Marprene are trademarks of Watson-Marlow Limited. STA-PURE PFL® and STA-PURE PCS® are registered trademarks of W.L Gore & Associates Inc. Please state the product code when ordering pumps and tubing.



wmfts.com/global
28 October 2025