

APEX28

APEX hose pumps



Hose Pumps

Features and benefits

- Seal-less, valve-less design
- Precision machined hose elements for accurate, repeatable performance
- Optimized hose compression for unmatched flow stability
- Direct-coupled drive and maximum flexibility - no separate couplings to align or maintain
- Ultra compact design with flexibility to mount standard gear motors - rotor supported by own bearings to maximize gearbox life
- Lower maintenance costs - single component change means fewer spare parts inventory



APEX28 performance

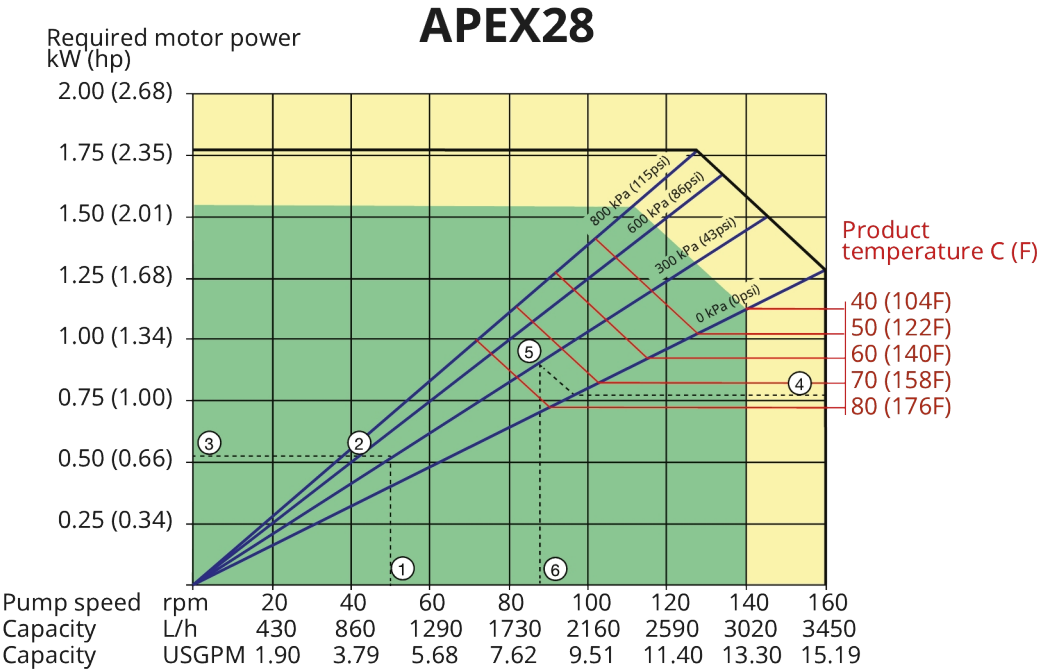

Technical specifications

	APEX28
Max. flow rate continuous	797 USGPH (3020 L/h)
Max. flow rate intermittent	910 USGPH (3450 L/h)
Volume per revolution	0.095 USG (0.36 l)
Max. continuous operating speed	140 rpm
Max. intermittent operating speed	160 rpm
Max. operating pressure	116 psi (8 bar)
Suction pressure	0.05 bar abs
Suction pressure	0.73 psi abs
Max. inlet pressure	37 psi abs (2.5 bar abs)
Operating temperature	-4 °F to 113 °F (-20 °C to 45 °C)
Fluid temperature	-4 °F to 176 °F (-20 °C to 80 °C)
Min. starting torque	1330 in.lbs (150 N m)
Weight	220 lbs (100 kg)
Port configurations	Down, Left, Right, Up
Compatible hose materials	EPDM, NBR, NBR for food, NR
Flange assembly type	ANSI, DIN, JIS

Materials of construction

	APEX28
Hose material	EPDM, NBR, NBR for food, NR
Housing	Cast iron
Rotor assembly	Die-cast aluminum
Cover assembly	Die-cast aluminum
Brackets	Cast iron, Stainless steel AISI 316L
Fasteners	Galvanized steel, Stainless steel AISI 316L
Support frame	Galvanized steel, Stainless steel AISI 316L
Coupling bush	Alloy steel
Seals	NBR

APEX28 dimensions

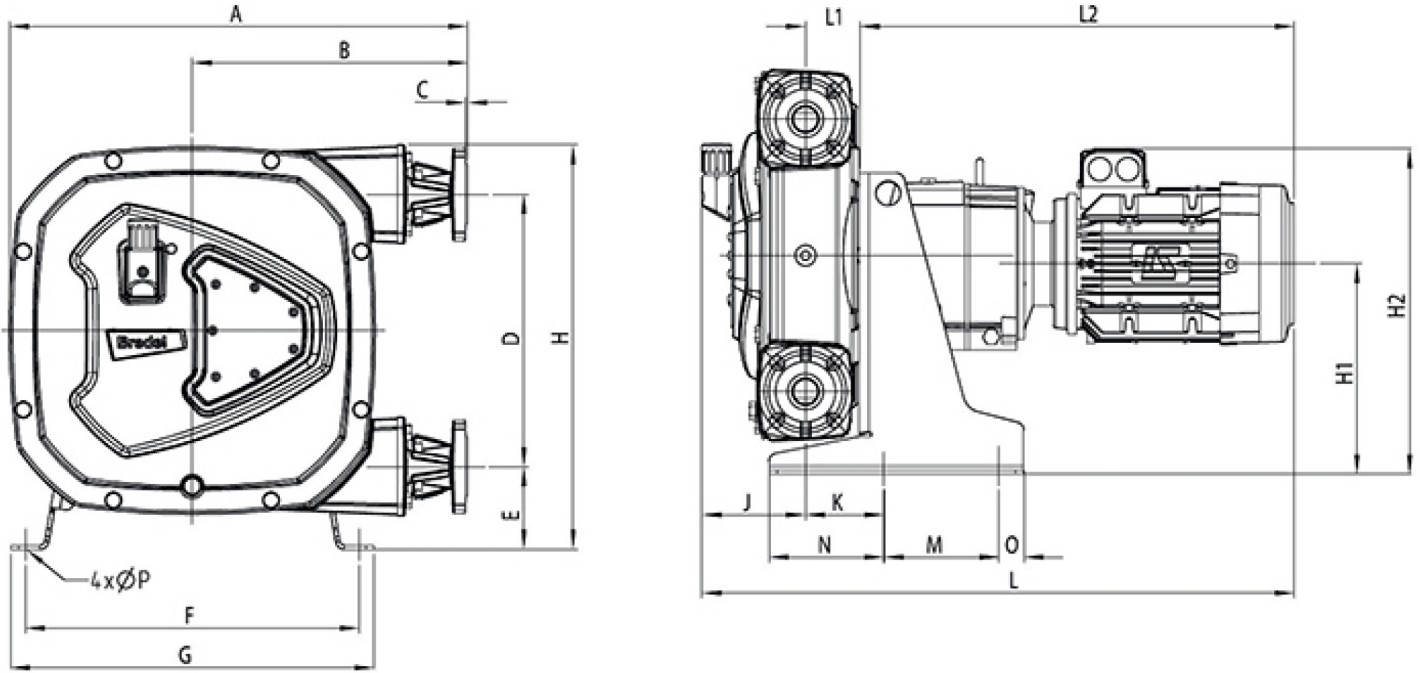

	A	B	C	D	E	F	G	H	H1	H2max	J	K	Lmax	L1	L2max	M	N	O	ØP
APEX28 (mm)	481	297	2.5	264	98	338	370	415	221	359	124	82.5	714	63	528	152	121	27	12
APEX28 (inch)	18.9	11.7	0.1	10.4	3.9	13.3	14.6	16.3	8.7	14.1	4.9	3.2	28.1	2.5	20.8	6.0	4.8	1.1	0.5
Connector sizes	ASME B16.5, 150# (ANSI)							EN 1092-1, PN40 (DIN)					JIS B2220, 10/16/20 kgf/cm²						
APEX28	DN 1"							DN 25					25mm						

Product codes

Disclaimer: The information contained in this document is believed to be correct at the time of publication, but Watson-Marlow Bredel BV accepts no liability for any error it contains, and reserves the right to alter specifications without prior notice. All mentioned values in this document are values under controlled circumstances at our test bed. Actual flow rates achieved may vary because of changes in temperature, viscosity, inlet and discharge pressures and/or system configuration. APEX, DuCoNite, Bioprene and Bredel are registered trademarks.



wmfts.com/global
11 July 2025