

Technical specifications

	Bredel Heavy Duty 50
Max. flow rate continuous	2774 USGPH (10512 L/h)
Max. flow rate intermittent	4623 USGPH (17520 L/h)
Volume per revolution	0.77 USG (2.92 l)
Max. continuous operating speed	60 rpm
Max. intermittent operating speed	100 rpm
Max. operating pressure	232 psi (16 bar)
Max. inlet pressure	38 psi abs (2.5 bar abs)
Max. suction capability	374 inWC (9.5 mWC)
Suction capability (80% Flow rate)	315 inWC (8 mWC)
Operating temperature	-4 °F to 113 °F (-20 °C to 45 °C)
Fluid temperature	-4 °F to 176 °F (-20 °C to 80 °C)
Min. starting torque	5487 in.lbs (620 N m)
Weight	879 lbs (399 kg)
Heavy Duty bracket weight	7 kg
Heavy Duty bracket weight	15.4 lbs
Window guard weight	5.4 lbs (2.4 kg)
Heavy Duty support frame weight	187 lbs (85 kg)
Hose lubricant required	2.64 USG (10 l)
Port configurations	Down, Left, Right, Up
Heavy Duty support frame weight	2 std bearings
Compatible hose materials	CSM, EPDM, F-NBR, NBR, NBR for food, NR-Metering, NR-Transfer
Flange assembly type	ANSI, DIN, JIS

Please consult your Bredel representative for lower or higher temperature operation.
Allowable ambient temperature is based on pump capabilities and may be further limited by gearbox ambient capabilities.

Materials of construction

	Bredel Heavy Duty 50
Hose material	CSM, EPDM, F-NBR, NBR, NBR for food, NR Endurance, NR-Transfer
Housing	Cast iron, ISO12944 category C4H, ISO12944 category C4M, ISO12944 category C5M
Rotor assembly	Cast iron, ISO12944 category C4M
Cover assembly	Cast iron, ISO12944 category C4M
Brackets and fasteners	Cast iron, Galvanized steel, ISO12944 category C4M, Stainless steel 316
Support frame	Galvanized steel, ISO12944 category C4H, ISO12944 category C5M, Stainless steel 316
Coupling bush	Alloy steel
Seals	Neoprene, Nitrile, Thermoplastic polyurethane
	ISO12944 category C4H, Steel

Bredel Heavy Duty 50 dimensions

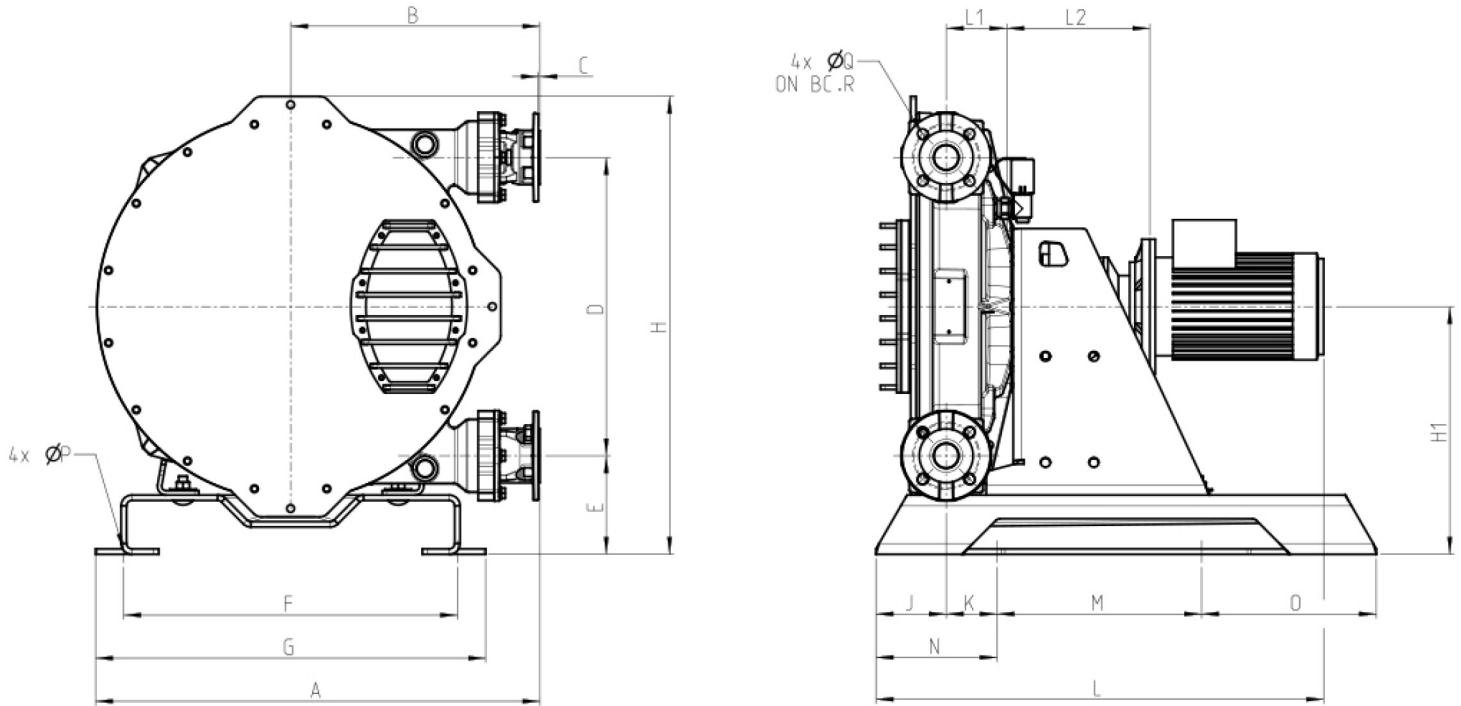

Type	A	B	C	D	E	F	G	H	H1	J	K	Lmax	L1	L2max	M	N	O	ØP	ØQ	R
Bredel 50 (mm)	826	464	3	554	183	620	725	851	460	131	95	1022	112	339	380	225	325	18	18	125
Bredel 50 (inches)	32.5	18.3	0.12	21.8	7.2	24.4	28.5	33.5	18.1	5.2	3.7	40.2	4.4	13.3	15	8.9	12.8	0.71	0.71	4.9
Connector sizes	ANSI 150#											EN DIN				JIS				
Bredel 50	2"											50mm				50mm				

Disclaimer: The information contained in this document is believed to be correct at the time of publication, but Watson-Marlow Bredel BV accepts no liability for any error it contains, and reserves the right to alter specifications without prior notice. All mentioned values in this document are values under controlled circumstances at our test bed. Actual flow rates achieved may vary because of changes in temperature, viscosity, inlet and discharge pressures and/or system configuration. APEX, DuCoNite, Bioprene and Bredel are registered trademarks.



wmfts.com/global
22 August 2025