

Bredel Heavy Duty 40



Hose Pumps

Bredel Heavy Duty pumps

Features and benefits

- Heavy duty frame: designed for safer pump transportation, using a forklift truck
- Window guard: extra protection for the inspection window
- Reinforced brackets: more robust design, less risk of lubricant leakage, easier maintenance
- C4H paint: enhanced durability in highly corrosive environments



Bredel Heavy Duty 40 performance

Bredel 40

Required motor power kW (hp)

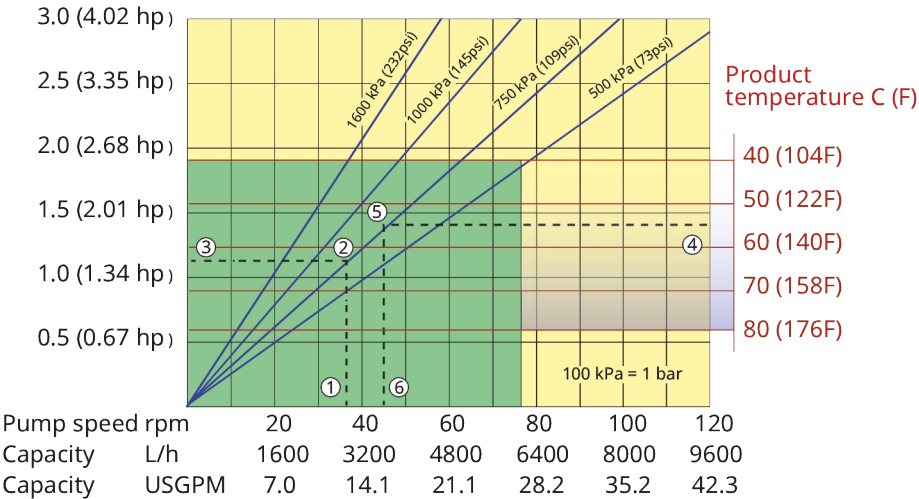

Note: The area of continuous operation diminishes with increased product temperatures. For product temperatures >40C, the area of continuous operation reduces to the corresponding red temperature line.

1. Flow required indicates pump speed
2. Calculated discharge pressure
3. Net motor power required
4. Product temperature
5. Calculated discharge pressure
6. Maximum recommended pump speed

- Continuous duty
- Intermittent duty

* Maximum 3 hours operation followed by minimum 1 hour stop

Technical specifications

| | Bredel Heavy Duty 40 |
|------------------------------------|---|
| Max. flow rate continuous | 1579 USGPH (5985 L/h) |
| Max. flow rate intermittent | 2527 USGPH (9576 L/h) |
| Volume per revolution | 0.35 USG (1.33 l) |
| Max. continuous operating speed | 75 rpm |
| Max. intermittent operating speed | 120 rpm |
| Max. operating pressure | 232 psi (16 bar) |
| Max. inlet pressure | 38 psi abs (2.5 bar abs) |
| Max. suction capability | 374 inWC (9.5 mWC) |
| Suction capability (80% Flow rate) | 354 inWC (9 mWC) |
| Operating temperature | -4 °F to 113 °F (-20 °C to 45 °C) |
| Fluid temperature | -4 °F to 176 °F (-20 °C to 80 °C) |
| Min. starting torque | 2832 in.lbs (320 N m) |
| Weight | 480 lbs (218 kg) |
| Heavy Duty bracket weight | 5.5 kg |
| Heavy Duty bracket weight | 12.1 lbs |
| Window guard weight | 2.6 lbs (1.2 kg) |
| Hose lubricant required | 1.32 USG (5 l) |
| Port configurations | Down, Left, Right, Up |
| Heavy Duty support frame weight | 2 std bearings |
| Compatible hose materials | CSM, EPDM, F-NBR, NBR, NBR for food, NR-Metering, NR-Transfer |
| Flange assembly type | ANSI, DIN, JIS |

Please consult your Bredel representative for lower or higher temperature operation.
Allowable ambient temperature is based on pump capabilities and may be further limited by gearbox ambient capabilities.

Materials of construction

| | Bredel Heavy Duty 40 |
|------------------------|---|
| Hose material | CSM, EPDM, F-NBR, NBR, NBR for food, NR Endurance, NR-Transfer |
| Housing | Cast iron, ISO12944 category C4H, ISO12944 category C4M, ISO12944 category C5M |
| Rotor assembly | Cast iron, ISO12944 category C4M |
| Cover assembly | Cast iron, ISO12944 category C4M |
| Brackets and fasteners | Cast iron, Galvanized steel, ISO12944 category C4M, Stainless steel 316 |
| Support frame | Galvanized steel, ISO12944 category C4H, ISO12944 category C5M, Stainless steel 316 |
| Coupling bush | Alloy steel |
| Seals | Neoprene, Nitrile, Thermoplastic polyurethane |
| | ISO12944 category C4H, Steel |

Bredel Heavy Duty 40 dimensions

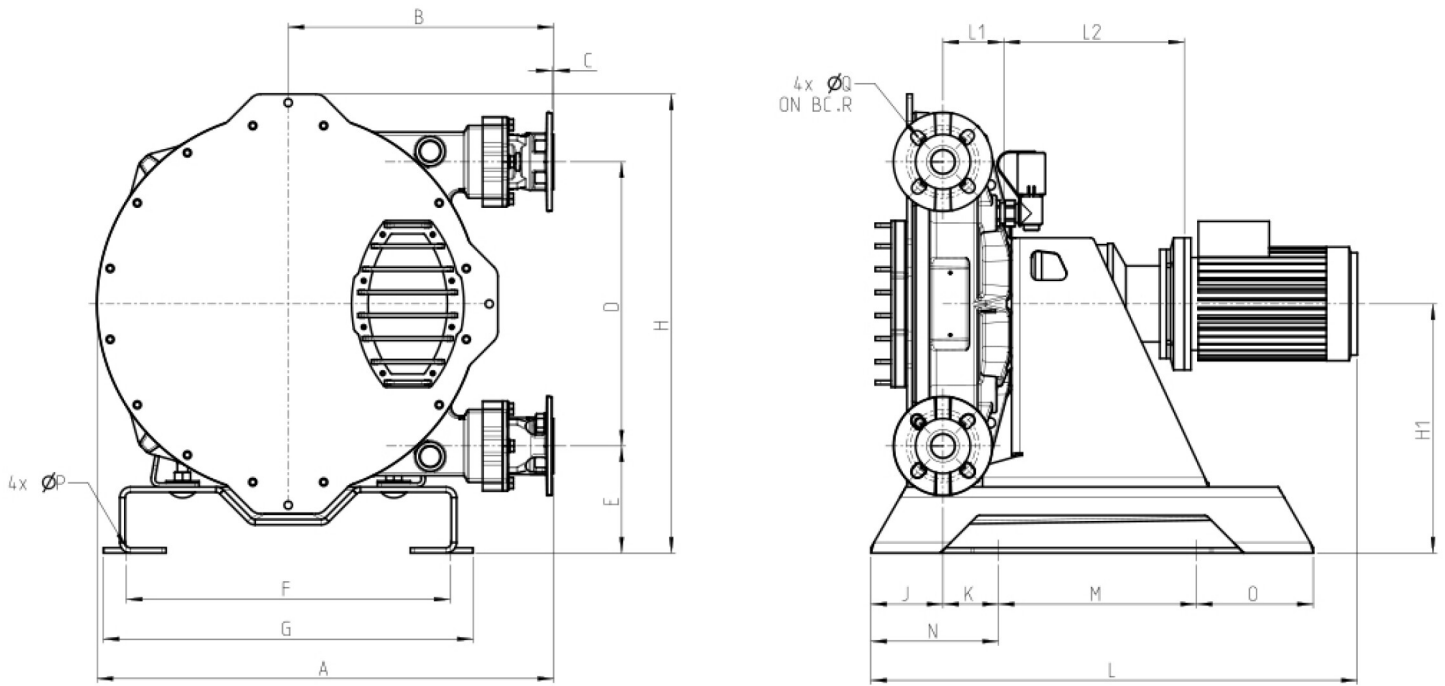

| Type | A | B | C | D | E | F | G | H | H1 | J | K | Lmax | L1 | L2max | M | N | O | ØP | ØQ | R |
|------------------------|------------------|------|------|------|-----|------|-----|------|------|-----|-----|------|---------------|-------|------|-----|------------|------|------|-----|
| Bredel 40 (mm) | 692 | 402 | 2.5 | 430 | 162 | 490 | 560 | 695 | 377 | 109 | 84 | 942 | 91 | 301 | 300 | 193 | 177 | 18 | 18 | 110 |
| Bredel 40 (inches) | 27.2 | 15.8 | 0.09 | 16.9 | 6.4 | 19.3 | 22 | 27.4 | 14.8 | 4.3 | 3.3 | 37.1 | 3.6 | 11.9 | 11.8 | 7.6 | 7.0 | 0.71 | 0.71 | 4.3 |
| Connector sizes | ANSI 150# | | | | | | | | | | | | EN DIN | | | | JIS | | | |
| Bredel 40 | 1.5" | | | | | | | | | | | | 40mm | | | | 40mm | | | |

Disclaimer: The information contained in this document is believed to be correct at the time of publication, but Watson-Marlow Bredel BV accepts no liability for any error it contains, and reserves the right to alter specifications without prior notice. All mentioned values in this document are values under controlled circumstances at our test bed. Actual flow rates achieved may vary because of changes in temperature, viscosity, inlet and discharge pressures and/or system configuration. APEX, DuCoNite, Bioprene and Bredel are registered trademarks.



wmfts.com/global
22 August 2025